

## 1926-27 Body Repair Parts

### Recessed Firewall, Fiberglass

A 3-piece unit. The outer firewall mounts to the body and has a reverse flange for the recess opening. An adaptor ring and a back firewall/floorboard section mount to this. The recess can be adjusted from 2" to 6" by trimming flanges on the outer firewall and the back firewall during installation. Made with Fire-retardant resin.

FW2627R 500.00 ea



### Roadster & Touring Patch Panels, Steel

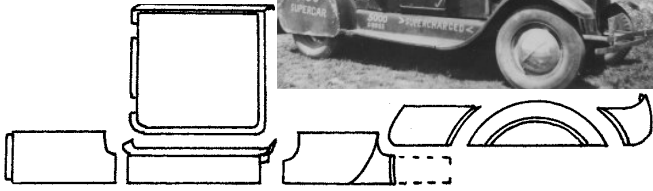

T-114-E	Cowl patch panels	55.00 pr
T-136-ER	Door outer panel, RH front	135.00 ea
T-136-EL	Door outer panel, LH front	135.00 ea
T-736-ER	Door outer panel, RH rear, touring	160.00 ea
T-736-EL	Door outer panel, LH rear, touring	160.00 ea
T-139-E	Rocker under front door, no script	55.00 pr
T-139-RE	Rocker under rear door, no script, touring	65.00 pr
T-750-E	Center (between door) patch, Touring	60.00 pr
T-150-E	Quarter patch panel, roadster	100.00 pr
T-850-E	Quarter Patch Panels, Roadster PU	100.00 pr
T-170-EF	Turtle deck front corner patch	55.00 pr
T-181-E	Turtle deck wheelwell patch	55.00 pr
T-170-E	Turtle deck rear corner patch	65.00 pr

### Roadster & Touring Front Seat Back, Steel

T-167-EB	Roadster bulkhead panel with stock bead	225.00 ea
T-167-EBP	Roadster bulkhead panel, no bead	185.00 ea
T-767-E	Touring front seat back*	300.00 ea

\* note: may require significant bodywork.

### Coupe & Tudor Door Patch Panels, Steel

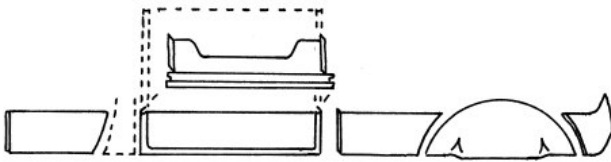

T-314-E	Cowl Patch Panels, Coupe & Tudor	55.00 pr
A-836-A	Door outer patch panels, 5" tall	100.00 pr
A-836-AT	Door outer patch RH, 22" tall	105.00 ea
A-836-ATL	Door outer patch LH, 22" tall	105.00 ea
A-836-IA	Door inner patch panels	50.00 pr
T-350-E	Quarter Patch Panels, Coupe	55.00 pr
T-450-E	Quarter Patch Panels, Tudor	55.00 pr
T-381-E	Wheelwell patch panels, Coupe	55.00 pr
T-370-E	Body rear corner patch, Coupe	65.00 pr
T-470-E	Body rear corner patch, Tudor & Touring	35.00 pr

### Deck Lids

Fiberglass deck lids have inner and outer panels bonded together with internal steel reinforcing.



Coupe

### 1926-27 Roadster (includes steel upper drip channel)

DL2627RS	with key dimple on outer panel	850.00 ea
DL2627RF	smooth (filled key dimple)	850.00 ea

### 1926-27 Coupe

DL2627C	with key dimple on outer panel	850.00 ea
---------	--------------------------------	-----------

### Coupe & Roadster Deck Lid Opening Panels, Steel

T-163	Panel below deck lid, roadster	60.00 ea
T-363	Panel below deck lid, coupe	60.00 ea
T-169-E	Deck opening side gutters, roadster	170.00 pr
T-369-E	Deck opening side gutters, coupe	170.00 pr

### Sedan & Touring Back Body Panel, Steel

Note: these panels may require significant bodywork.

T-463-E	Tudor sedan	170.00 ea
T-763-E	Touring	170.00 ea
T-563-E	Fordor sedan	160.00 ea
T-470-26S	Rear body T strip, pre-formed, Sedan	65.00 ea

### Roadster and Touring Floor and Sills

T-131-E	Floor cross sills	60.00 pr
T-135-E	Panel under front seat, 1926 style	55.00 ea
T-135-F	Panel under front seat, 1927 style	60.00 ea
T-159-E	Trunk floor w/crossmember hump, roadster	350.00 ea

### Coupe and Tudor Floor and Sills

T-331-E	Floor cross sills, set of 3	90.00 set
T-335-E	Panel under front seat, 1926 style	55.00 ea
T-335-F	Panel under front seat, 1927 style	60.00 ea
T-359-E	Trunk floor w/crossmember hump, coupe	170.00 ea
T-365-E	Rear body crossmember, coupe	80.00 ea

### Body Wood Kits

Wood kits are manufactured from hardwood, usually oak. Top wood kits include the wood above top of the doors, including the windshield & door header wood, when used. The body wood kits include the door post, window surround, and any other body wood below the top of the doors.

Body wood kits do not include door, floor, or seat wood.

TWD-1240	Top wood, 1926-27 Coupe	675.00 set
TWD-1273	Body wood, 1926-27 Coupe	350.00 set
TWD-1240	Top wood, 1926-27 Tudor Sedan	675.00 set
TWD-1273	Body wood, 1926-27 Tudor Sedan	350.00 set
TWD-1244	Body wood with tack strip, Roadster	450.00 ea
TWD-1244-2	Cockpit tack strip only, Roadster	250.00 ea
TWD-1247	Body wood with tack strips, Touring	875.00 ea
TWD-1247-2F	Front cockpit tack strip only, Touring	250.00 ea
TWD-1247-2R	Rear cockpit tack strip only, Touring	300.00 ea

\* Parts with price listed as "not.avbl" are not known to be available at this time, but are listed for reference.

### Special Hardware

#### Rear Wheelwell Fender Studs

*These are the large head studs that weld into the wheelwell for rear fender mounting on 1928-32 Passenger cars and 1932-47 Pickup boxes.*

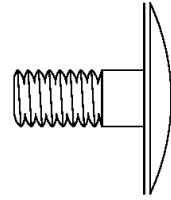

AH-1173	Set of 4	2.50	set
---------	----------	------	-----

#### Cage Nuts

*A nut in a sheetmetal cage to weld or braze into the body.*

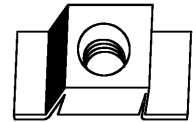

AH-3145-B	43834	1.50	ea
AH-3145	45428	1.50	ea
AH-3145-D	45359	5.00	ea
AH-3145-E	41276	2.50	ea

#### Capped nuts for exposed wood

*Stainless Steel, used extensively on station wagons*

AH-352353-SF	5/16-24, .75 cap dia, .35 thread depth	3.00	ea
AH-352353-LL	5/16-18, .75 cap dia, .60 thread depth	3.00	ea
AH-352353-SS	5/16-18, .75 cap dia, .35 thread depth	3.00	ea
AH-352353-SC	3/8-24, .90 cap dia, .60 thread depth	3.00	ea

#### "D" Nuts

*These are the special D shaped clinch nuts used extensively on Ford bodies. They are inserted into their hole and the flange is peened down to rivet them into the hole.*



AH-1123-A	11963	0.50	ea
AH-1123	40901	0.50	ea
AH-1123-B	43834	1.00	ea
AH-1123-D	45428	2.50	ea
AH-1123-C	45359	2.50	ea
AH-1123-E	44028	2.50	ea

#### Body Nails

*.074 dia x 3/4", .165 dia, Oval head, straight shank*

AH-0003-C	100 qty	1.50	ea
AH-0003-5C	500 qty	7.50	ea

*.085 dia x 7/8", .165 dia, flat head, twist shank*

AH-0004-C	100 qty	2.00	ea
AH-0004-5C	500 qty	12.50	ea

#### Body Insulation

HR-700770	Heavy duty foil backed jute 36" x 48"	30.00	ea
-----------	---------------------------------------	-------	----

\* Parts with price listed as "not.avbl" are not known to be available at this time, but are listed for reference.