

1933-34 Coupe, Roadster, Sedan, and Phaeton Body Repair Parts

1933-34 Passenger Front Floorboards (original type)

40-700325	Front floorboards, wood (1 piece)	not.avbl
AH-3141	Floorboard mount screws, 28 pcs	5.00 set
40-700394	Pedal/steering to floorboard seal	10.00 ea
40-700378	Transmission cover, steel	90.00 ea
AH-3142	Trans cover mount screws, 14 pcs	5.00 set
A-35130-S	Front floorboard to body seal, felt	15.00 ea
40-700382	Transmission top to floor rubber pads	10.00 ea
B-35184	Bumpers for brake & clutch pedals	7.50 pr
VWD-3334A-BATT	Battery opening wood cover	85.00 ea

Street Rod Firewall and Front Floorboards

Firewall: Smallblock

BN-331051 475.00 ea

Firewall: Bigblock

BN-331008 475.00 ea

Front floor/transmission hump

(use with original firewall)

BN-331066 325.00 ea

use with smallblock firewall

BN-331053 350.00 ea

use with bigblock firewall

BN-331060 350.00 ea

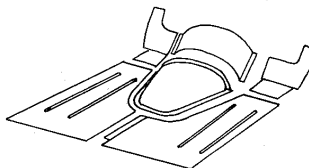
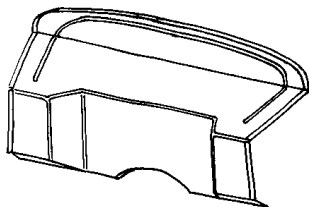

Floor Pans

Complete floor with sills:

40-130-SC Stock 2700.00 ea

40-130-RC Rod 2375.00 ea

Assembled pan without sills

40-130-S Stock 2025.00 ea

40-130-R Rod 1800.00 ea

Flat Pan w/o sills: Street Rod

Multiple sections follow frame contour to eliminate suspension clearance problems and allow easy shipping.

BN-331065 350.00 ea

Front floor section

37", Optional battery cutouts

40-135 LH 450.00 ea

40-135-DB Dual 450.00 ea

40-135-F None 450.00 ea

Center floor section

40-151 Stock style w/driveline hump, full width 500.00 ea

40-151-R Stock style w/driveline hump, LH only 225.00 ea

40-151-L Stock style w/driveline hump, RH only 225.00 ea

40-151-SR Street rod, w/o hump and toe recess, full width 225.00 ea

Rear floor sections

40-155 Differential section, stock style 350.00 ea

40-155-SR Differential section, use with 40-151-SR 300.00 ea

40-161 Rear extension 145.00 ea

Street Rod Replacement Steel 1933-34 Floorpan Kits

These floor replacement kits are designed to eliminate clearance problems on street rods over the frame rear axle kickup. Available with rear seat footwell or flat for extra suspension clearance. Manufactured in multiple sections to allow UPS shipping.

BN-331065 Flat style, does not include sills 350.00 ea

Body Patch Panels

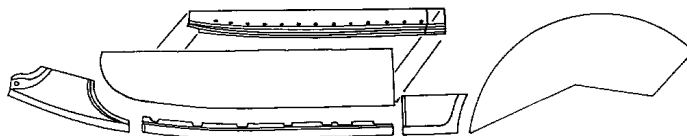

Cowl:

40-114 Cowl patch panels, Closed and Cabriolet 90.00 pr

40-132-X Front Cowl Body Mount (lower firewall) 80.00 pr

40-114-IR Cowl inner panel/toe support, RH 225.00 ea

40-114-IL Cowl inner panel/toe support, LH 225.00 ea

Door:

	RH		LH	
Outer, Roadster	40-136-R	70.00 ea	40-136-L	70.00 ea
Outer, 3W and Tudor	40-236-R	70.00 ea	40-236-L	70.00 ea
Outer, 5W and 4D ft	40-336-R	70.00 ea	40-336-L	70.00 ea
Outer, Cabriolet	40-636-R	70.00 ea	40-636-L	70.00 ea
Inner, 3W and Tudor	40-236-IR	60.00 ea	40-236-IL	60.00 ea
Inner, 5W and 4D ft	40-336-IR	60.00 ea	40-336-IL	60.00 ea
Inner, Cabriolet	40-636-IR	60.00 ea	40-636-IL	60.00 ea

Door opening

	RH		LH	
Header: 3 Window	40-239-UR	180.00 ea	40-239-UL	180.00 ea
Hinge post cvr: 3 Wdo	40-250-HPR	225.00 ea	40-250-HPL	225.00 ea
Header: 5 Window	40-339-UR	95.00 ea	40-339-UL	95.00 ea
Header: Tudor/Vicky	40-439-UR	80.00 ea	40-439-UL	80.00 ea

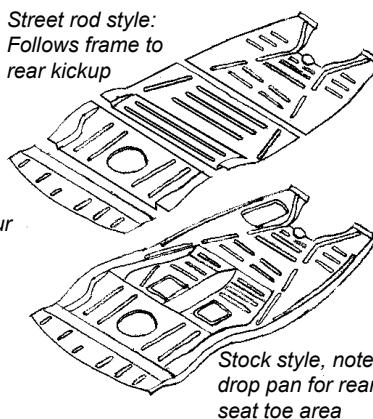

*Street rod style:
Follows frame to
rear kickup*

*Stock style, note
drop pan for rear
seat toe area*

1933-34 Coupe, Roadster, Sedan, and Phaeton Body Repair Parts, cont

BODY WOOD: Coupe/Sedan/Victoria/Sedan Delivery

Windshield

VWD-3334CS-WSHT	Windshield Header Tack Wood	65.00	ea
VWD-3334CS-WSH	Windshield Post	32.50	pr

Door Post/Door Header

VWD-34W3-DRPOST	1934 3 Window Door Post/Header	1675.00	pr
VWD-34W3-DRFILL	1934 3 Window Door Post filler	40.00	pr
VWD-3334W5-DRPT	1933-34 5 Window Door Post Lower Tack Wood	275.00	pr
VWD-3334W5-DRPU	1933-34 5 Window Door Post Upper Tack Wood	90.00	pr
VWD-3334W5-DRHD	1933-34 5 Window Door Header Wood	183.75	pr

VWD-33S2-DHDR	1933 Tudor Door Header: RH	not.avbl	
VWD-33S2-DHDL	1933 Tudor Door Header LH	not.avbl	
VWD-34S2-DHDR	1934 Tudor Door Header: RH	not.avbl	
VWD-34S2-DHDL	1934 Tudor Door Header LH	not.avbl	
VWD-3334S2-DPF	1933-34 Tudor Door Post Filler Wood	not.avbl	
VWD-3334S4-DHDR	1933-34 Fordor Door Header wood, RH	not.avbl	
VWD-3334S4-DHDL	1933-34 Fordor Door Header wood, LH	not.avbl	
VWD-3334S4-DPF	1933-34 Fordor Door Post Filler wood	not.avbl	
VWD-33V-DHDR	1933 Victoria Door header wood RH	not.avbl	
VWD-33V-DHDL	1933 Victoria Door header wood LH	not.avbl	

Back Window

	1933		1934		
Coupes: Header	VWD-33C-RWHEAD	105.00	ea	VWD-34C-RWHEAD	60.00 ea
Coupes: Side	VWD-33C-RWSIDE	60.00	pr	VWD-34C-RWSIDE	60.00 pr
Coupes: Regulator	VWD-3334C-RWREG	225.00	set	VWD-3334C-RWREG	225.00 set
Coupes: Corner	VWD-3334C-RWCNR	45.00	pr	VWD-3334C-RWCNR	45.00 pr
Sedan back window	VWD-33S2-RWDO	not.avbl			

Coupe Package Tray

VWD-3334W3-PACK	3 Window Package Tray	140.00	ea
VWD-3334W5-PACK	5 Window Package Tray	105.00	set

Top Ribs

VWD-3334C-TPRIB	3 Window and 5 Window	100.00	set
VWD-3334S2-TRIB	Tudor Sedan	350.00	set
VWD-3334S4-TRIB	Fordor Sedan	not.avbl	
VWD-33V-TRIB	1933 Victoria	not.avbl	
VWD-3334SD-TRIB	Sedan Delivery	not.avbl	

Top Dome Light Block

VWD-3334W3-DOME	Dome Light Block, 3 Window	32.50	ea
VWD-3334W5-DOME	Dome Light Block, 5 Window	35.00	ea

Cabriolet Wood Parts

VWD-3334C-WSHT	Windshied tack wood 3334 Cab	not.avbl	
VWD-3334N-PACK	Package tray assy 3334 Cabr	not.avbl	
VWD-3334C-TOOL	Trunk tool box wood 3334 CR	180.00	ea

Roadster and Phaeton Body Wood Parts

VWD-3334P-DREAR	Door frame wood RH/LH 3334PH	not.avbl	
VWD-3334P-RTACK	Rear body tack wood 3334PH	not.avbl	
VWD-3334P-SEFT	Front seat frame wood 3334PH	not.avbl	
VWD-3334P-SERB	Rear seat back wood 3334PH	not.avbl	
VWD-3334R-POSTD	Door post wood 3334Road	160.00	pr
VWD-3334R-DFRRH	Door frame wood RF 3334RPh	1450.00	ea
VWD-3334R-DFRLH	Door frame wood LF 3334Rph	1450.00	ea
VWD-3334R-COWL	Cowl wood 3334 RPH	1200.00	set
VWD-3334R-PACK	Package tray wood 3334 R	350.00	ea

* Parts with price listed as "not.avbl" are not known to be available at this time, but are listed for reference.

Special Hardware

Rear Wheelwell Fender Studs

These are the large head studs that weld into the wheelwell for rear fender mounting on 1928-32 Passenger cars and 1932-47 Pickup boxes.

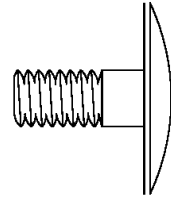

AH-1173	Set of 4	2.50	set
---------	----------	------	-----

Cage Nuts

A nut in a sheetmetal cage to weld or braze into the body.

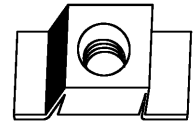

AH-3145-B	43834	1.50	ea
AH-3145	45428	1.50	ea
AH-3145-D	45359	5.00	ea
AH-3145-E	41276	2.50	ea

Capped nuts for exposed wood

Stainless Steel, used extensively on station wagons

AH-352353-SF	5/16-24, .75 cap dia, .35 thread depth	3.00	ea
AH-352353-LL	5/16-18, .75 cap dia, .60 thread depth	3.00	ea
AH-352353-SS	5/16-18, .75 cap dia, .35 thread depth	3.00	ea
AH-352353-SC	3/8-24, .90 cap dia, .60 thread depth	3.00	ea

"D" Nuts

These are the special D shaped clinch nuts used extensively on Ford bodies. They are inserted into their hole and the flange is peened down to rivet them into the hole.



AH-1123-A	11963	0.50	ea
AH-1123	40901	0.50	ea
AH-1123-B	43834	1.00	ea
AH-1123-D	45428	2.50	ea
AH-1123-C	45359	2.50	ea
AH-1123-E	44028	2.50	ea

Body Nails

.074 dia x 3/4", .165 dia, Oval head, straight shank

AH-0003-C	100 qty	1.50	ea
AH-0003-5C	500 qty	7.50	ea

.085 dia x 7/8", .165 dia, flat head, twist shank

AH-0004-C	100 qty	2.00	ea
AH-0004-5C	500 qty	12.50	ea

Body Insulation

HR-700770	Heavy duty foil backed jute 36" x 48"	30.00	ea
-----------	---------------------------------------	-------	----

* Parts with price listed as "not.avbl" are not known to be available at this time, but are listed for reference.